

# ZØRE

## **ZORE-X**

---

**CORE SERIES 9x19**

Owner's Manual

Watch the video before initial use  
[www.zore.life/firstuse](http://www.zore.life/firstuse)



This booklet is designed to provide information on how to properly install and remove your ZØRE-X lock. Please retain this for future reference. It is important that you understand all warnings, recommendations, operation instructions and safety procedures before attempting to use the ZØRE-X lock.

ALWAYS PRACTICE SAFE FIREARM HANDLING AND BE MINDFUL OF THE FIREARM SAFETY COMMANDMENTS! FIREARMS ARE DANGEROUS AND POTENTIALLY LETHAL, ESPECIALLY WHEN USED IMPROPERLY OR UNSAFELY.

## **WARNINGS**

**Your ZØRE-X lock is not a substitute for safe, proper and careful gun handling and storage. It is your responsibility to know how to safely handle and securely store your firearm. FAILURE TO FOLLOW ALL FIREARMS SAFETY GUIDELINES MAY RESULT IN SEVERE INJURY OR DEATH.**

**PLEASE READ THIS ENTIRE BOOKLET AND YOUR OWNER'S MANUAL PROVIDED WITH YOUR FIREARM BEFORE ATTEMPTING TO SECURE YOUR FIREARM WITH THIS LOCK. Observe all the warnings and instructions in this booklet and the firearm owner's manual when using this gun lock.**

**Before installing the ZØRE-X lock, be sure the firearm is NOT LOADED (i.e.: a round is not in the chamber), the magazine is removed and the safety is on.**

**Keep your finger off the trigger and point the firearm in a safe direction when installing and removing your ZØRE-X lock.**

**This product is intended to be used solely as a lock to help prohibit unintended use of a firearm. It is not intended for any other uses or purposes.**

**While your ZØRE-X lock is made from high quality materials, nothing is indestructible; care should be taken to make sure your lock is not damaged, dropped, broken, cracked or destroyed prior to, or during use.**

This product is intended to discourage unauthorized access to the firearm, particularly by young children. No lock or safety device is fool proof. ZØRE-X may be defeated by a determined individual using tools or other aggressive means and will not prevent intentional misuse of a firearm. Given enough time, multiple attempts to discover the code may succeed in unlocking the device, dependent on the complexity of the code you choose.

**It is recommended that you store your firearm unloaded.** If you intend to store a loaded firearm, make sure to remove the magazine before ejecting the ZØRE-X lock to prevent the gun from chambering a round when the lock is removed. Extracting the lock from a gun with a loaded magazine installed will automatically chamber a round. **Consider the gun to be loaded as soon as the lock is ejected.**

Ejecting the lock will project it out of the gun. Make sure that the area is clear of people and objects.

The lock will not prevent theft. If you are interested in guarding your weapon against theft you will need to use an additional appropriate system.

## Check that ZORE-X is compatible with your specific gun model

This lock is suited to specific calibers and models. Check that your weapon appears on the compatibility list at [www.zore.life/compatibility](http://www.zore.life/compatibility)

**If you do not conduct this test, it is possible that the ZORE-X may get stuck inside your firearm.**

### Inside the ZØRE-X box

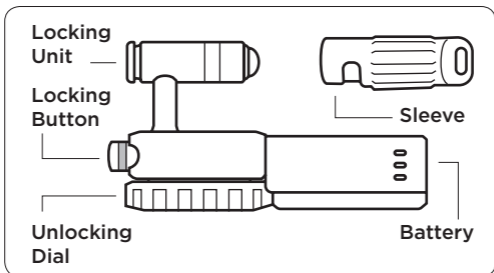

### Chamber shaped sleeve

The product arrives locked into a sleeve shaped like a barrel (see below for removal instructions). Save the sleeve. It is designed to allow you to practice using the product without the use of a firearm. It will also protect the device when it is not in use, and doubles as a handy key-ring.

# Backup code

ZØRE

ZØRE-X

Unlocking Backup Code

Scratch to see code

- To unlock your ZØRE-X for the first time please use this code
- It is also the backup "key" code in case you forget your code. Keep it in a secure place.
- This code is embedded in your device, and cannot be changed.
- It is critical that you protect this code from the eyes of anyone not authorized to use your weapon.
- For your privacy and security ZØRE does NOT keep a copy of this code, so it is wholly your responsibility to save it in a place where you can find it if necessary.

## First time you use the lock

The product arrives locked in a chamber shaped sleeve. In order to release it, enter the backup code.

1. Enter the code in the following manner: The dial counts the number of clicks. Reversing the direction starts the count of the next number. For example, if the code were: 6-5-4-3-2-1 (*Fig.1*)

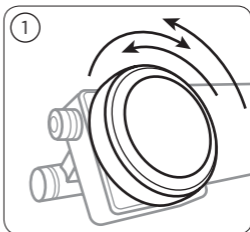

Start turning in one direction (it doesn't matter which). Count 6 clicks.

Turn in the other direction. Count 5 clicks.

Turn in the other direction. Count 4 clicks.

Turn in the other direction. Count 3 clicks.

Turn in the other direction. Count 2 clicks.

Turn in the other direction. Count 1 click.

It doesn't matter which direction you rotate the dial. It doesn't matter where the dial is when you begin rotation (there is no zero hash). When the device identifies the correct sequence, it will unlock, and the locking button will pop up. (*Fig.2,3*)

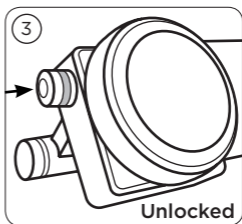
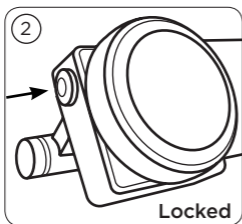

**Note:** The device is unlocked only when the yellow ring is **COMPLETELY** visible. (Fig. 4)

2. **Set your own personal code according to the instructions below.**

**The code can only be changed when the lock is open.**

- The code can contain up to 20 digits.
- Each digit can be from 1 to 9 clicks.
- **Note:** A strong code will include at least 5 digits.
- A code with less than 5 digits will be easy to 'crack' simply by playing with the dial.

The last rotation of the dial will unlock the device, even if you go past the number.

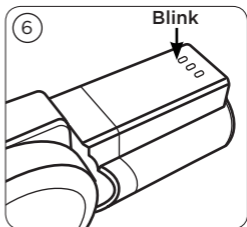
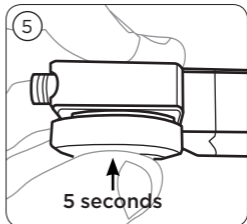
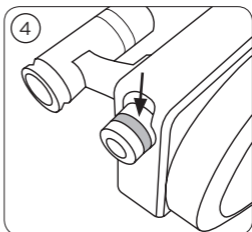

**Orange light begins to blink.**

## **Instructions for setting the code:**

1. Press the center of the dial and hold it down for 5 seconds (Fig.5), until the orange light begins to blink. (Fig.6)
2. Enter the code you wish to use (Fig.7), then press the center of the dial briefly (Fig.8), the orange light will stop blinking and the green light will begin to blink.
3. Enter your code a second time then press the center of the dial briefly (the green light will stop blinking). (Fig.8)
4. If the operation was successful, both the orange and green lights will light up for one second. (Fig.9)

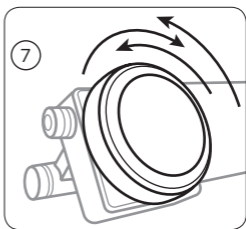

**Enter your code**

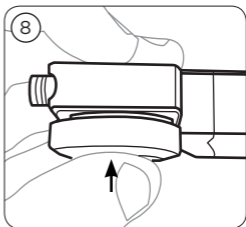

**Press briefly**

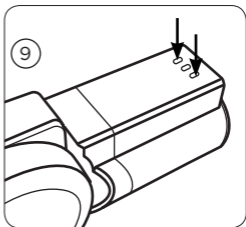

## **Daily use**

### **To lock:**

1. Make sure there is no magazine in the gun and that the gun's chamber is unloaded.
2. Lock the slide in the open position. (Fig.10)
3. Point the muzzle in a downward direction safely away from all bystanders and other objects.(Fig.10)
4. While ZØRE-X is unlocked, place the locking

unit in the chamber, pushing it all the way in. (Fig.11) In some gun models, the product won't fit itself into the chamber until the slide is returned, in this case, hold the ZORE-X lock with one hand while moving the slide forward all the way, until the product fits into the chamber.

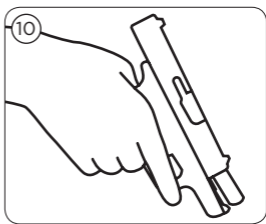

5. Release the slide and make sure it moves all the way to the forward position, and that the extractor has fit onto the extractor groove of the lock. (Fig.12,13)

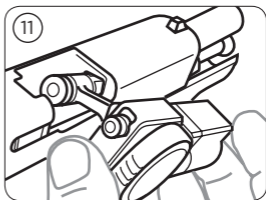

6. For guns with an external extractor that also acts as a loaded chamber indicator (Fig. 14), pressing on the back of the extractor will decrease the pressure on the extractor tooth, allowing for smoother closing of the slide on the ZORE-X lock.

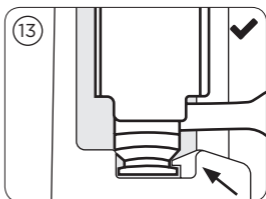
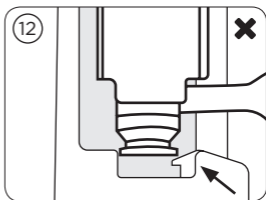

- 7. NOTE:** During the first use- before locking the ZORE-X lock - eject the

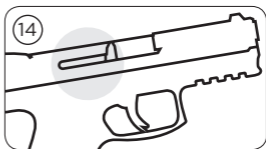



lock by racking the slide, checking that it ejects smoothly. IF IT DOES NOT, DO NOT LOCK THE ZORE-X. YOU MAY HAVE NON COMPATIBLE GUN MODEL.

8. To lock, enter your code. When entering a correct code the green light will turn on for one second. (Fig. 15)

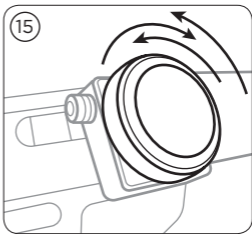

9. Press the locking button for about two seconds until the locking button remains in its locked position. (Fig. 16)

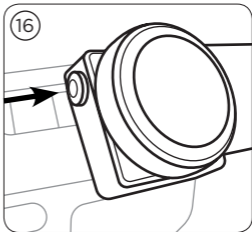

10. Make sure your ZORE-X is locked and sitting properly in the chamber with the extractor enclosed correctly within the extractor groove, by attempting to rack the slide.
11. You can now return the magazine to the gun.

## Note

Operation of the lock should always take place within the barrel or the accompanying sleeve. If you accidentally pressed the locking button when the lock was outside of your gun, and the locking unit is now in this position (A) As opposed to the normal position (B).

Insert the ZORE-X lock firmly into the sleeve, all the way in, and rotate the sleeve into

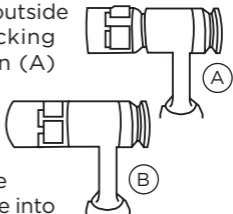

the groove. If the sleeve is not available, insert the ZORE-X lock into a gun and move the slide forward.

**Note: Without entering the code, the device will not lock.**

**To Open:**

1. Enter your code. When entering a correct code the green light will turn on for one second (Fig. 17)
2. When the lock button pops out, rack the slide. (Fig.18,19)

**Note: The device is unlocked only if the yellow ring is COMPLETELY visible.**

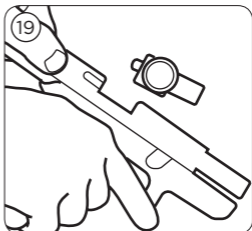
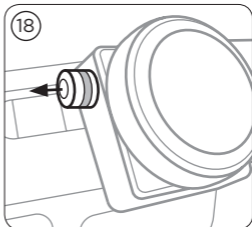
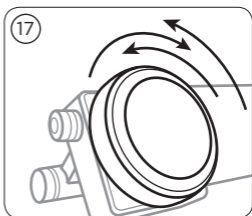

## **NOTE**

**To prevent extraction malfunction keep your fingers away from the ZORE-X lock while charging the firearm.(Fig 20-23).**

**Charge your gun with the same force as if you were loading a round.**

**The ZORE-X lock is designed to work properly when there is a loaded magazine in the gun. If you decide to practice such use, it is recommended to use dummy rounds for your own safety.**



If you do not want to chamber a round, make sure there is no magazine in the gun before removing the lock. It is recommended that you do not store a loaded gun.

It is recommended that during daily use, you remove your lock without letting it fall on a hard floor.

## Check battery status

Pressing on the dial for 2 seconds will activate the battery status indicator for one second (Fig. 24):

Green - Full

Orange - Weak (battery should be replaced)

Red - Battery drained

(It is not possible to lock the device in this state)

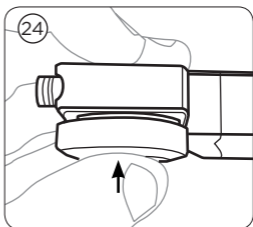
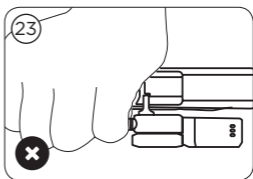
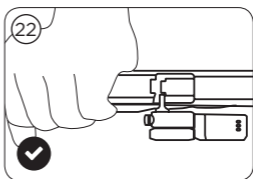
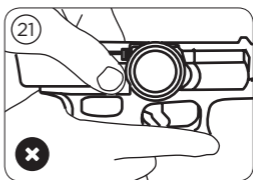
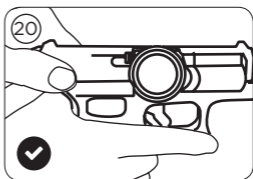

Press for one second

## Replacing the battery

- Your ZORE-X uses a CR2 battery (3.0v).
- Open the battery cover with a screwdriver or coin. (Fig. 25)
- Remove the old battery and replace it with a new one, with the plus sign (+) facing inwards.
- Close the battery cover.
- Press the dial for 2 seconds to check the battery indicator. It should be green..

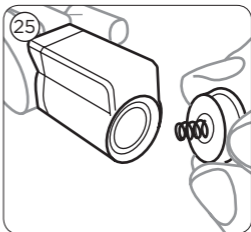

## Regular maintenance

Suggestions for weekly care:

1. Check the battery status by pressing the dial
2. Eject the device from your gun to practice operating it, making sure to follow all safety instructions.



**WARNING:** Do not leave the lock exposed to extreme heat or cold for extended periods of time, and do not expose it to extreme humidity or to sand.

## Troubleshooting

Before you begin using the lock, check that your weapon appears on the compatibility list.

If the lock does not open, make sure that the code was entered correctly.

Possible problems:

<b>Problem</b>	<b>Troubleshooting</b>
<b>When charging the gun, the ZORE-X lock did not eject smoothly.</b>	To prevent extraction malfunction keep your fingers away from the ZORE-X lock while charging the firearm. Charge your gun with the same force as if you were loading a round. Remember, that the ZORE-X lock is designed to work properly when there is a loaded magazine in the gun. If you decide to practice such use, it is recommended to use dummy rounds for your own safety.

**The locking button will not remain in the pressed position.**

Re-enter the code and wait for the green light to come on. Then, hold down the button for at least 5 seconds, until it remains locked. If the red button lights up instead of the green button, change the battery.

**The ZORE-X lock is unresponsive**

Press the center of the dial and hold it down for 15 seconds to reset the device. (A reset does NOT reset your code). All the indicator lights will light up. If still unresponsive, open the battery cover and close it. If this does not work, replace the battery according to the instructions above.

**The locking button only partially pops out. (The yellow ring is only partially visible)**

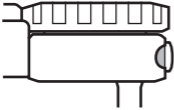

If the ZORE-X lock is inside the gun: Strike a blow to the back of the slide. If this does not work, rattle the ZORE-X lock up and down.  
If the ZORE-X lock is inside the sleeve: Push the ZORE-X lock all the way in, and turn it into the groove of the sleeve.

**If the code doesn't open the lock / or you forgot the code**

Use the backup code sent with the lock. If this does not work, press the center of the dial and hold it down for 15 seconds to reset the ZORE-X lock, then retry the backup code.

**The locking unit in this position:**

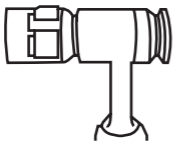

**As opposed to the normal position:**

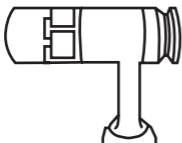

Insert the ZORE-X all the way into the sleeve and rotate the sleeve into the groove. If the sleeve is not available, insert the ZORE-X lock into a gun and move the slide forward.

When inserting the ZORE-X lock into a gun, the slide does not fully close and the extractor does not reach the extractor groove on the lock.

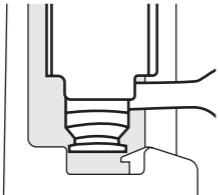
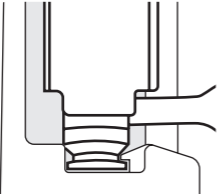

For guns with an external extractor that also acts as a loaded chamber indicator

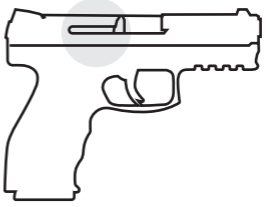

pressing on the back of the extractor will decrease the pressure on the extractor tooth, allowing for smoother closing of the slide on the lock. On guns without this option, lightly hit the back of the slide, until you see that the extractor has fit onto the extractor groove (cartridge rim). If this does not work, shake the ZORE-X lock up and down, then try again.



<p><b>The ZORE-X lock is locked in the gun and I can rack the slide back but the ZORE-X lock remains locked in the barrel.</b></p>	<p>This is a sign that the extractor did not engage correctly with the extractor groove when the ZORE-X lock was inserted. Follow the instructions of the procedure directly above this line.</p>
<p><b>The locking button popped up fully (The yellow ring is COMPLETELY visible) but the ZORE-X lock does not eject when racking the slide.</b></p>	<p>Hold the ZORE-X lock and rattle it forwards and backwards. Try to rack the slide by pulling back on the ZORE-X lock itself forcefully.</p>
<p><b>When holding down the dial the ZORE-X lock does not enter a restart or code reset.</b></p>	<p>Turn the dial several clicks and try again.</p>
<p><b>In the rare case that the ZORE-X lock does not unlock after entering the correct code.</b></p>	<p>Press the center of the dial and hold it down for 15 seconds to reset the device, until all three indicator lights light up, then try again. If this does not work, strike a blow to the back of the slide and rattle it up and down. If after the reset the indicator lights do not light up, follow the troubleshooting procedure for “The lock is unresponsive”.</p>

**Weak battery: the battery indicator lights up orange or red.**

Replace the battery according to the instructions in the "Replacing the battery" section.

If you encounter a problem you are not able to solve, please log into your personal page on our website for additional support: **[www.zore.life](http://www.zore.life)**

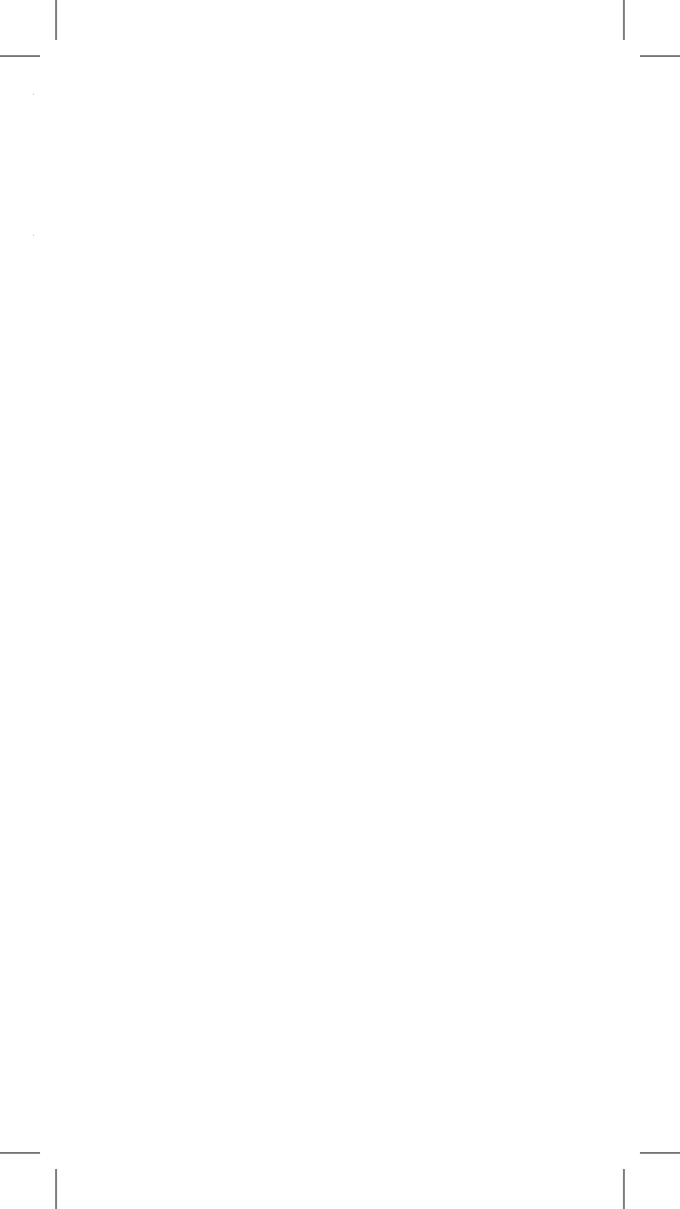

## **Satisfaction Policy**

Zore is committed to customer satisfaction and is pleased to provide a thirty (30) day satisfaction guarantee from the date You receive the product (“Satisfaction Guarantee Period”). If You are dissatisfied with Your purchase during the Satisfaction Guarantee Period, You may return Your order using Zore’s website platform. You will have to pay for the return shipment to Zore of any products returned under Zore’s satisfaction guarantee policy, as well as twenty-five dollar (\$25.00) handling fee..

All returns must contain all original packaging, as well as a full functional product. Broken or malfunctioning products may be returned under Zore’s warranty policy but not under this satisfaction guarantee policy. Zore reserves the right to reject any satisfaction guarantee return if it appears that the product was mishandled or mistreated by You or subject to abnormal or unexpected use. All such determinations by Zore are final and binding upon You. If Your satisfaction guarantee return is accepted and approved by Zore, you will receive a reimbursement of the price paid by You for the product, less any discounts, within thirty (30) days of such acceptance.

Upon expiration of the Satisfaction Guarantee Period, orders cannot be returned for a refund or a new item, except for valid warranty claims, without Zore’s express written consent.

## Warranty Policy

All Zore products have a Limited Warranty to cover any manufacturer's defects in material or workmanship under normal use during the Warranty Period of twenty-four (24) months from the date of Your purchase ("Warranty Period"). All warranty claims shall be instituted through Zore's website platform. You will have to pay for the shipment to Zore for all products submitted under a warranty claim, as well as a twenty dollar (\$20.00) per product diagnostic fee. You will be contacted by Zore with the results of the diagnostic test. If Zore determines that the product presents a valid Limited Warranty claim, Your product shall be repaired or replaced by Zore, at its sole discretion, You will receive a sixty (60) day extension of this Limited Warranty, and Zore will reimburse reasonable shipment costs up to five dollars (\$5.00) per item. Zore will also reimburse the diagnostic fee. Any such reimbursement shall be within forty-five (45) days of the warranty claim approval by Zore. Repair and/or replacement timing may vary. If Zore determines that the product is not covered by Zore's Limited Warranty, You will have the option to pay for the repair. Zore charges a flat repair fee of one hundred and ten dollars (\$110.00) per lock, which includes the twenty dollar (\$20.00) per product diagnostic fee, for any repairs not covered Zore's Limited Warranty. If You chose not to pay for the repair, You will not be reimbursed the previously paid diagnostic fee.

This Limited Warranty does not cover problems that are caused by conditions, malfunctions or damage not resulting from defects in material or workmanship of the products. The Limited Warranty is void if any modification or alteration

is made to the original product or if the product is damaged through abnormal or unexpected use. Zore alone shall determine whether the use of the product causing damage is normal, and covered by the Limited Warranty, or abnormal, and not covered by the Limited Warranty. All such determinations by Zore are final and binding upon You. ZORE SHALL HAVE THE RIGHT EITHER TO REPLACE OR REPAIR ANY DEFECTIVE PRODUCTS, TO REFUND THE PURCHASE PRICE UPON RETURN OF THE PRODUCTS OR TO GRANT A REASONABLE ALLOWANCE ON ACCOUNT OF SUCH DEFECTS. ZORE'S LIABILITY, AND YOUR EXCLUSIVE REMEDY, FOR DEFECTIVE PRODUCTS SHALL BE LIMITED SOLELY TO REPLACEMENT, REPAIR, REFUND OR ALLOWANCE, AS ZORE MAY ELECT.

TO THE FULLEST EXTENT PERMITTED BY APPLICABLE LAW, ZORE AND/OR ITS SUPPLIERS HEREBY DISCLAIM ALL WARRANTIES, OTHER THAN THOSE EXPRESSLY PROVIDED BY ZORE HEREIN, INCLUDING ALL IMPLIED WARRANTIES OF MERCHANTABILITY, FITNESS FOR A PARTICULAR PURPOSE, TITLE AND NON-INFRINGEMENT. TO THE EXTENT THAT APPLICABLE LAW DOES NOT PERMIT FOR SUCH A DISCLAIMER, ZORE AND/OR ITS SUPPLIERS HEREBY LIMIT ALL EXPRESS AND IMPLIED WARRANTIES TO TWENTY-FOUR (24) MONTHS FROM THE DATE OF YOUR PURCHASE.



ZØRE